

STUDIO BLU

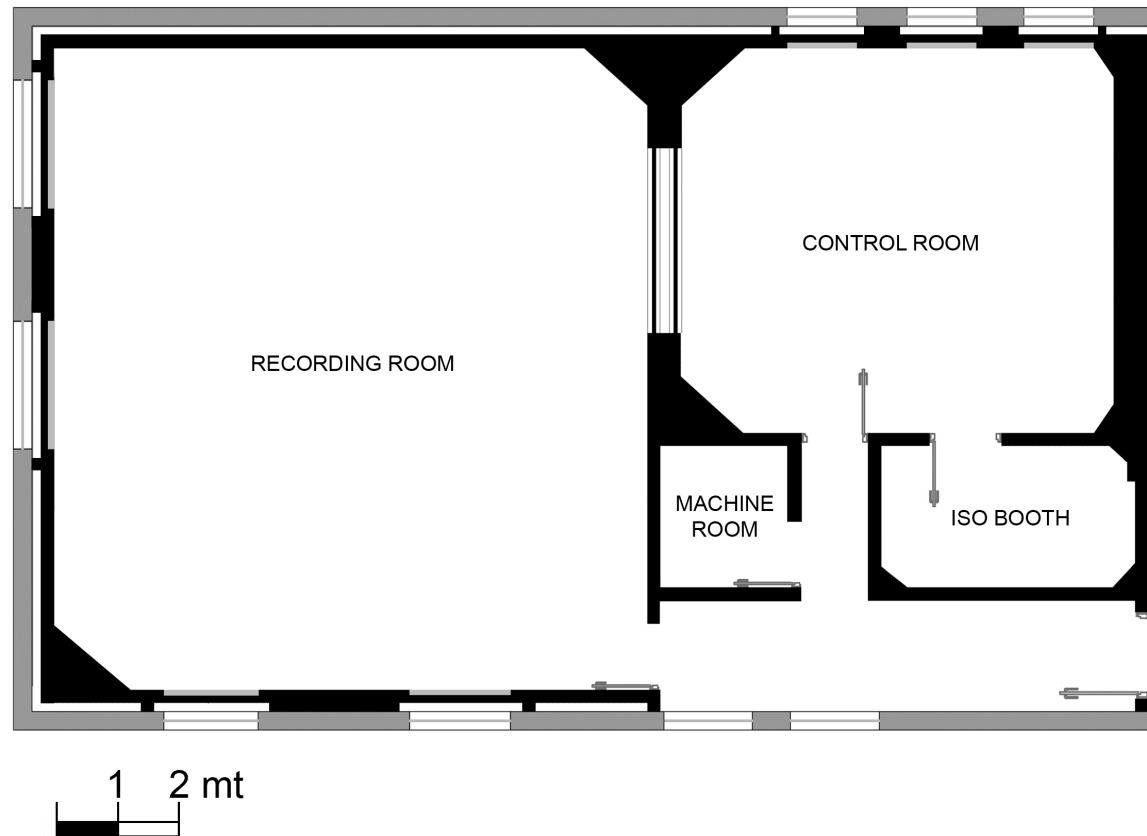

Acoustic design: Robert Perkmann

RECORDING ROOM

Length: 10,4 mt – 34,12 ft

Width: 11,6 mt – 38,048 ft

Height: 5,39 mt – 17,67

Clear Height: 5,07 mt -

Reverberation Time: 1,298 s

Floor area: 120,64 mq – 1.298,55 ftq

CONTROL ROOM

Floor area: 44 mq – 473,61 ftq

ISO BOOTH

Floor area: 9,47 mq – 101,93 ftq

TECHNICAL EQUIPEMENT

MIXER

1 RND 5088 40CH

MONITOR

2 QUESTED - V2108 NEARFIELD

1 QUESTED - SBC800 LFE/Sub-Bass Controller 1

QUESTED - QSB118

2 YAMAHA – NS 10

1 YAMAHA – SW10 STUDIO

2 YAMAHA – NS 40

MONITORING CONTROLLER ANALYZER

1 RTW – 1062 X PLUS

2 HEAR TECHNOLOGIES – HEAR BACK HUB

16 HEAR TECHNOLOGIES – HEAR BACK MIXER

WORLD CLOCK GENERATOR

1 BRAINSTORM – DCD 8

AUDIO INTERFACE

1 DIGIDESIGN – HD CORE

1 DIGIDESIGN – HD ACCEL

1 DIGIDESIGN – SYNCH HD

CONVERTER

1 SSL – DELTA LINK MADI HD

3 SSL – ALPHA LINK

OUTBOARD

10 NEVE 1073LB MIC PRE

2 AVALON – AD 2022 MIC PRE

1 SSL X-LOGIC ALPHA VHD PRE

1 UNIVERSAL AUDIO – 2-610

1 MASELEC – MEA2

2 MASELEC – MLA2

1 NEVE – 33609/J

1 TUBE-TECH LCA-2B

1 AVALON – AD 2044

2 UREI – 1176 LN

4 EMPIRICAL LABS – EL8X – DISTRESSOR

1 TL AUDIO – C1 DUAL VALVE COMPRESSOR

1 BSS DPR 402

2 SSL X-RACK

1 LEXICON – 480L + LARC

1 LEXICON PCM91

1 YAMAHA – SPX 2000

1 ROLAND CHORUS ECHO

PLAYER - RECORDER

TASCAM - CDRW901SL

KEYBOARD

YAMAHA – CLP 330 M

SOFTWARE

PROTOOLS HD8