

## STUDIO ROSSO

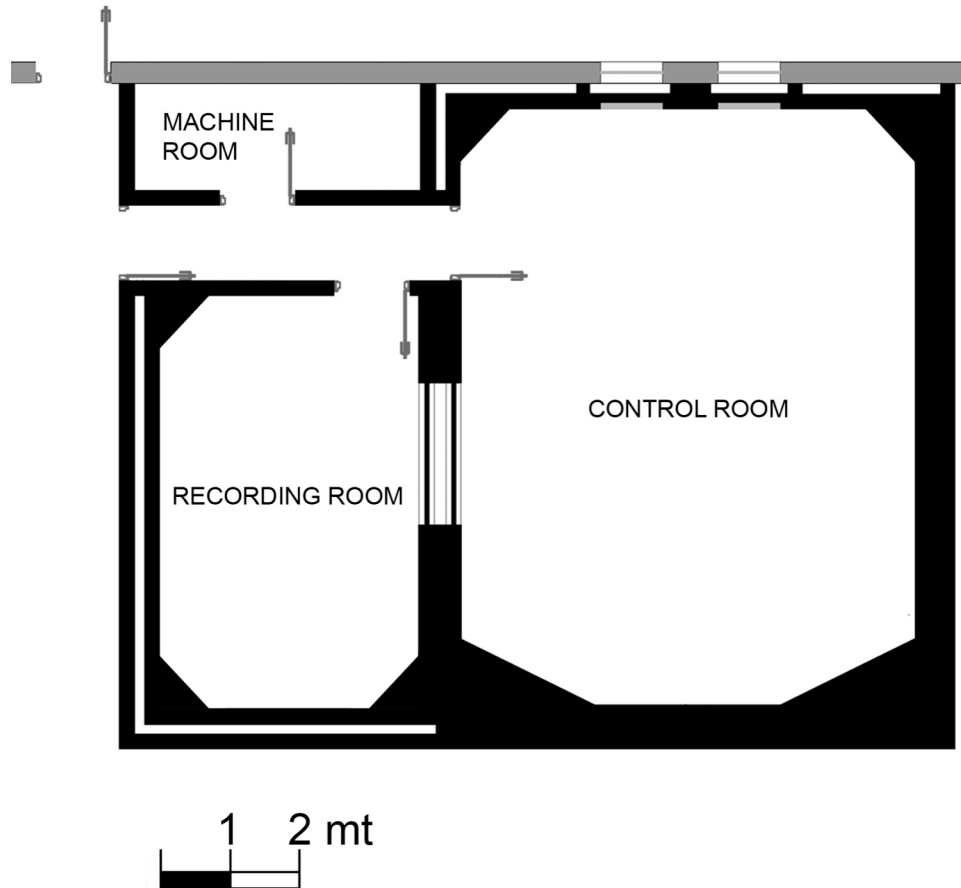

**Acoustic design: Robert Perkmann**

### RECORDING ROOM

**Length: 5,75 mt – 18,86 ft**

**Width: 3,65 mt – 11,97**

**Height: 3,06 mt – 10,03**

**Reverberation Time: 0,67 s**

**Floor area: 21 mq – 226,04 ftq**

### CONTROL ROOM

**Floor area: 51 mq – 548,95 ftq**

**TECHNICAL EQUIPEMENT**

**MIXER**

1 SSL MATRIX SUPERANALOGUE

**MONITOR**

1 TIVOLI AUDIO - MODEL ONE  
2 YAMAHA - NS 10  
2 GENELEC - 8050A  
5 YAMAHA - MSP7  
1 YAMAHA - SW10 STUDIO  
2 ADAM – S3X H  
1 ADAM - SUB12

**MONITORING CONTROLLER ANALYZER**

1 RTW - 10600 PLUS  
1 TASCAM - MH-40 MK II

**WORLD CLOCK GENERATOR**

1 BRAINSTORM - DCD-8

**AUDIO INTERFACE**

1 RME - HDSPe MADI AES  
2 SSL - DUENDE  
1 DIGIDESIGN - HD CORE  
1 DIGIDESIGN - HD ACCEL  
1 DIGIDESIGN - SYNCH HD

**CONVERTER**

1 SSL - DELTA LINK  
1 SSL - ALPHA LINK  
1 RME - AD6432  
1 TASCAM - MA-AD8  
1 TASCAM - IF-DA8

**OUTBOARD**

2 SSL - XLOGIC G-SERIES COMPRESSOR  
1 TL AUDIO INDIGO SERIES COMPRESSOR  
1 MASELEC - MEA2  
1 MASELEC - MLA2  
1 EMPIRICAL LABS FATSO  
1 UNIVERSAL AUDIO 2-610 DUAL PREAMP  
1 FOCUSRITE - RED 1 PREAMP  
1 DOLBY SYSTEM - A TYPE  
1 LEXICON - 480L + LARC

**SOFTWARE**

PRO TOOLS HD8  
NUENDO 5  
SEQUOIA 12

**PLAYER - RECORDER**

TEAC TASCAM SERIES – 85-16  
TASCAM - DA-40  
TASCAM DA-88  
DENON DN-C615  
SONY - MDS-JE520  
SONY - TC-WE435  
1 STUDER A 80 ¼ - ½ pollice 2 tracks  
1 STUDER A 80 4 tracks  
1 STUDER B 67 2 tracks  
1 REVOX B 77 2 tracks  
1 REVOX B 77 4 tracks  
1 TASCAM – CD-160  
1 SONY DTC-670  
1 TASCAM CD-A5000  
1 TECHNICS – SP15 MK3  
2 TECHNICS – SL1210 MK2  
1 KEITH MONKS – OMNI MK VII